



DF250560

Dishwasher 200 series

fully integrated

Height 81.5 cm

15 place setting capacity.
6 programmes with aqua sensor and 2 options, Power and Intensive:
Clean and dry dishes in 80 minutes
Intensive cleaning in the lower basket while protecting glassware in the upper basket
TFT display for intuitive handling of all functions
Bright interior lighting
Aqua stop with guarantee

Handling

TFT display indicating remaining or end time, refill for salt and rinsing agent, inflow of water.
Touch key operation.
Information key with use indications.
Time delay up to 24 hours.
Visual and acoustic end of programme indicator.
Info-Light.

Technical Features

Bright interior lighting.
Glass protection.
Aqua sensor.
Load sensor.
Automatic detergent function.
Heat exchanger.
Continuous flow heater.
Triple filter system.
Soft lock.
Child lock.
Aqua stop with guarantee.

Programmes

6 programmes:
Auto 35 °C - 45 °C.
Auto 45 °C - 65 °C.
Auto 65 °C - 75 °C.
Standard Eco 45 °C.
Quick wash 45 °C (29 min.).
Pre-rinse.
2 options:
Intensive.
Power.

Features

Flexible basket system.
Cutlery drawer.
Upper basket:
Rackmatic with 3 levels, adjustable in height up to 5 cm.
2 folding spines.
2 folding racks.
Lower basket:
4 folding spines.
2 folding racks.
15 international place settings
Maximum dish sizes (upper/lower basket)
27/25, 24.5/27.5 or 22/31 cm respectively.
Noise level 40 dB (re 1 pW).

Consumption data

4 Star energy rating, 5 Star WELS water rating
12 L water consumption per wash.
From 0.64 kWh.

Planning notes

Height-adjustable feet.
Appliance plinth recess 100 mm (see drawing).
Rear feet adjustable at front.
Door weight up to 8.5 kg.
Door panel dimension dependent on plinth height of kitchen furniture.
For installation into a tall unit, ventilation openings are recommended (min. 200 cm²).

Characteristics

Water consumption (l)

12.0

Built-in / Free-standing

Built-in

Height of removable worktop (mm)

0

Required niche size for installation (HxWxD)

815-875 x 600 x 550

Depth with open door 90 degree (mm)

1150

Adjustable feet

Yes - front only

Maximum adjustability feet (mm)

60

Adjustable plinth

Net weight (kg)

41.830

Gross weight (kg)

44.0

Connection Rating (W)

2400

Current (A)

10

Voltage (V)

220-240

Frequency (Hz)

50; 60

Length electrical supply cord (cm)

175

Plug type

AU plug

Length inlet hose (cm)

165

Length outlet hose (cm)

190

EAN code

4242006278847

Consumption and connection features

Number of place settings

15

Energy efficiency class (2010/30/EC)

Energy consumption annual (kWh/annum)

0.64

Energy consumption (kWh)

0.64

Power consumption in left-on mode (W) - NEW (2010/30/EC)

Power consumption in off-mode (W) - NEW (2010/30/EC)

Water consumption annual (l/annum)

Drying performance

Reference programme

Eco

Total cycle time of reference programme (min)

170

Noise level (dB)

40

Installation typology

Full-integrated

2019-04-30

Page 1

Connection

Total connected load 2.4 kW.
Connecting cable pluggable.
Water connection with 3/4" screw joint.
Connection to hot or cold water possible.

Color Variants

DF250560

fully integrated

Height 81.5 cm

Included accessories

1 x baking tray spray head.

Installation Accessories

GH045010

Handle bar with 2 mounts, stainless steel, Length 45 cm, drilling distance 427 mm

GAGGENAU

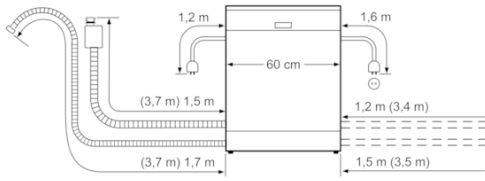

() Werte mit Verlängerungssatz

Connection dimensions for a 60 cm wide dishwasher

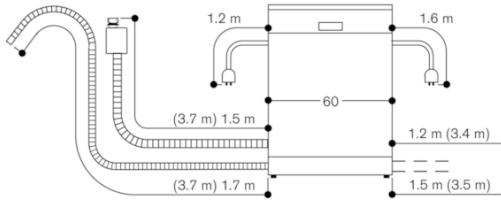

() values with extension kit

81.5 cm high dishwasher

