

KDIAM90AX

Smeg 90cm concealed undermount rangehood



EAN 8017709217082

| | |
|----------------|--|
| dimensions | 900mmW x 360mmH x 258mmD |
| finish | stainless steel |
| installation | concealed within cupboards or island bulkhead |
| motor | 550 watt |
| capacity | 1555m ³ /hr (IEC 61591) |
| air extraction | duct direct to atmosphere or recirculate to kitchen, 150mm ducting required |
| noise rating | 46 dBA (IEC 60704-2-13) |
| extraction | direct duct to atmosphere, 150mm ducting required recirculate to kitchen, 150mm diameter ducting required |
| illumination | 4 x 1W LED |
| speeds | 3 + intensive |
| filtration | 2 x stainless steel baffle filters + replacement indicators |
| option | activated charcoal filters, part number FLT6 |
| warranty | 2 years parts and labour |

| | Extraction rate m ³ /hr (IEC 61591) | Noise level dBA (IEC 60704-2-13) |
|-----------|---|-------------------------------------|
| Speed 1 | 552 | 46 |
| Speed 2 | 950 | 63 |
| Speed 3 | 1412 | 71 |
| Intensive | 1555 | 74 |

KDIAM90AX

Smeg 90cm concealed undermount rangehood

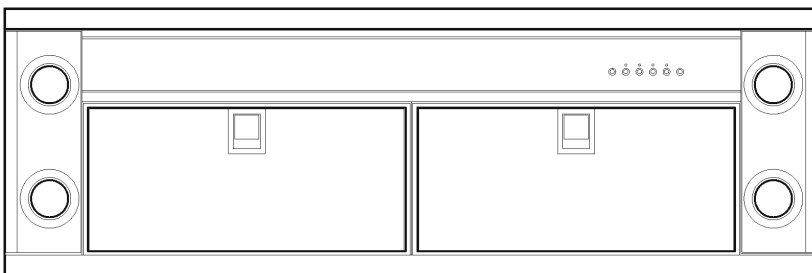
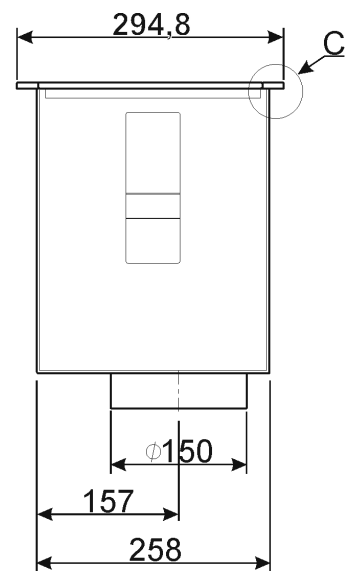
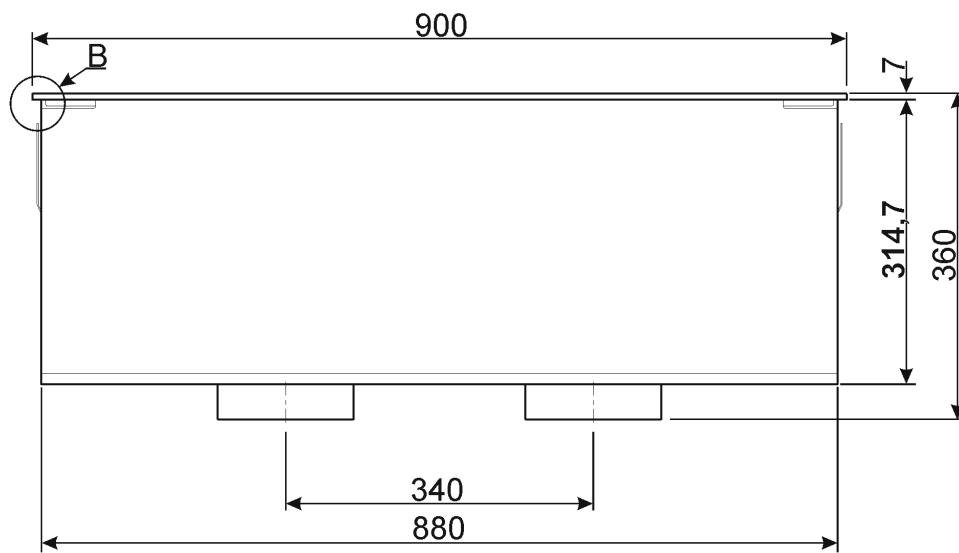
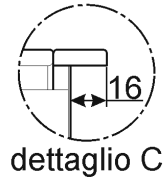
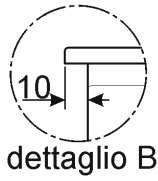

PLEASE NOTE: drawings are not to scale. They are to assist only.